

Helima aluminium spacer profiles

Manufacture:

Lingermann GmbH
Am Deckershäuschen 62
D-42111 Wuppertal
Germany

Material data:

When modelling the profiles following material data has been used:

Materials	λ in W/m ² K
Aluminium	160*
Dessicant	0.13*
Butyl	0.24*
Polysulfide	0.40*

*Materials for which the manufacture has not specified exact material data, values from prEN ISO 10077-2 has been used:

Normal spacers:

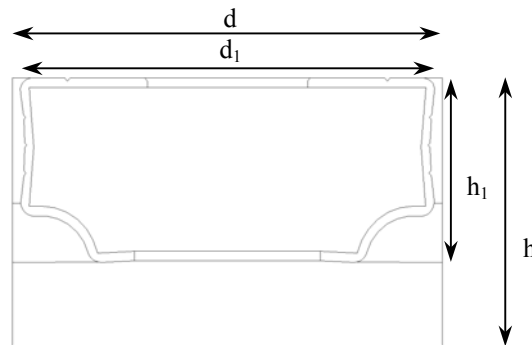

Calculations on the spacers has been performed using 0.3 mm butyl rubber along both sides of the spacer and 3 mm polysulfide along the lower part of the spacer.

Profile id.	Dimensions (With butyl & polysulfide) d×h (mm)	d (mm)	d1 (mm)	h (mm)	h1 (mm)	Equivalent thermal conductivity [W/mK]		L value [W/mK]
						Old method	New method	New method
Helima 5.5	6.1×9.6	6.1	5.5	9.6	6.6	1.02	1.40	2.20
Helima 8.5	9.1×9.6	9.1	8.5	9.6	6.6	1.39	2.00	2.11
Helima 11.5	12.1×9.6	12.1	11.5	9.6	6.6	1.76	2.30	1.82
Helima 13.5	14.1×9.6	14.1	13.5	9.6	6.6	1.99	2.30	1.77
Helima 14.5	15.1×9.6	15.1	14.5	9.6	6.6	2.11	2.60	1.65
Helima 15.5	16.1×9.6	16.1	15.5	9.6	6.6	2.22	2.80	1.67
Helima 17.5	18.1×9.6	18.1	17.5	9.6	6.6	2.44	3.00	1.59
Helima 19.5	20.1×9.6	20.1	19.5	9.6	6.6	2.64	3.30	1.58
Helima 21.5	22.1×9.6	22.1	21.5	9.6	6.6	2.84	3.60	1.56
Helima 23.5	24.1×9.6	24.1	23.5	9.6	6.6	3.03	3.80	1.51

